

372

375

377/2

38

257

259

3



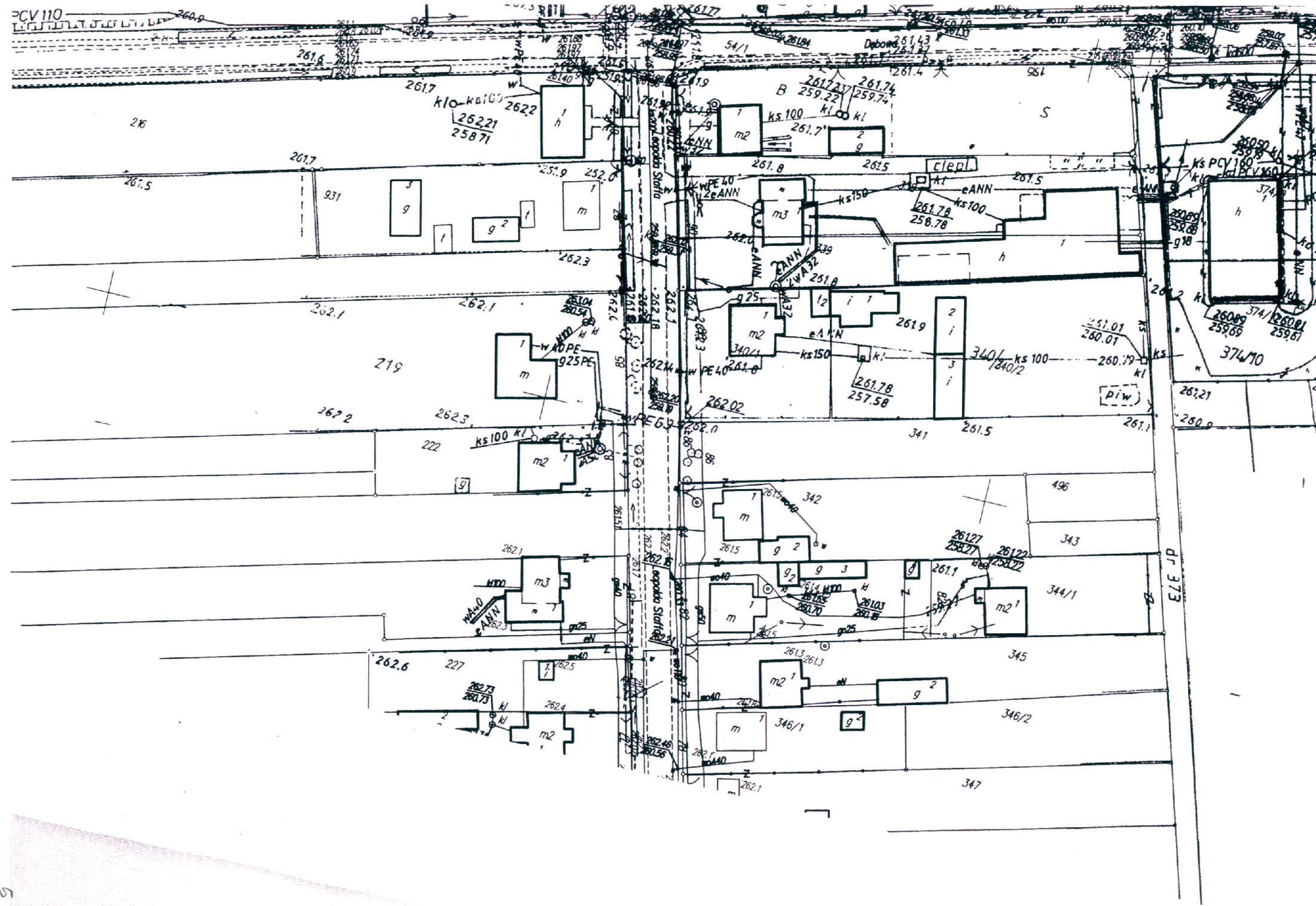

PCV 110

260.09 / 259.66  
374 / 1280.01  
259.61  
374.70

DR 373

KIO-Kb100  
262.21  
258.71

B  
261.73 / 259.74  
261.74  
259.74

261.78 / 258.78

261.78 / 257.58

261.27 / 258.27  
261.22 / 258.22

WADO  
925PE

340/1  
ks150

340 / 1840/2  
ks 100

26

219

222

227

262.73 / 260.73

262.4

262.1

346/1

g 1

347

346/2

345

344/1

343

496

341

piw

261.21

260.9

261.1

260.19

ks

kl

260.01

251.01

261.01

260.01

261.01

260.01

261.01

260.01

261.01

260.01

261.01

260.01

261.01

260.01

261.01

260.01

261.01

260.01

262.1

262.1

262.1

262.1

262.1

262.1

262.1

262.1

262.1

262.1

262.1

262.1

262.1

262.1

262.1

262.1

262.1

262.1

262.1

262.1

262.1

262.1

262.1

262.1

262.1

262.1

262.1

262.1

262.1

262.1

262.1

262.1

262.1

262.1

262.1

262.1

262.1

262.1

262.1

262.1

262.1

262.1

262.1

262.1

262.1

262.1

262.1

262.1

262.1

262.1

262.1

262.1

262.1

262.1

262.1

262.1

262.1

262.1

262.1

262.1

262.1

262.1

262.1

262.1

262.1

262.1

262.1

262.1

262.1

262.1

262.1

262.1

262.1

262.1

262.1

262.1

262.1

262.1

262.1

262.1

262.1

262.1

262.1

262.1

262.1

262.1

262.1

262.1

262.1

262.1

262.1

262.1

262.1

262.1

262.1

262.1

262.1

262.1

262.1

262.1

262.1

262.1

262.1

262.1

262.1

262.1

262.1

262.1

262.1

262.1

262.1

262.1

262.1

262.1

262.1

262.1

262.1

262.1

262.1

262.1

262.1

262.1

262.1

262.1

262.1

262.1

262.1

262.1

262.1

262.1

262.1

262.1



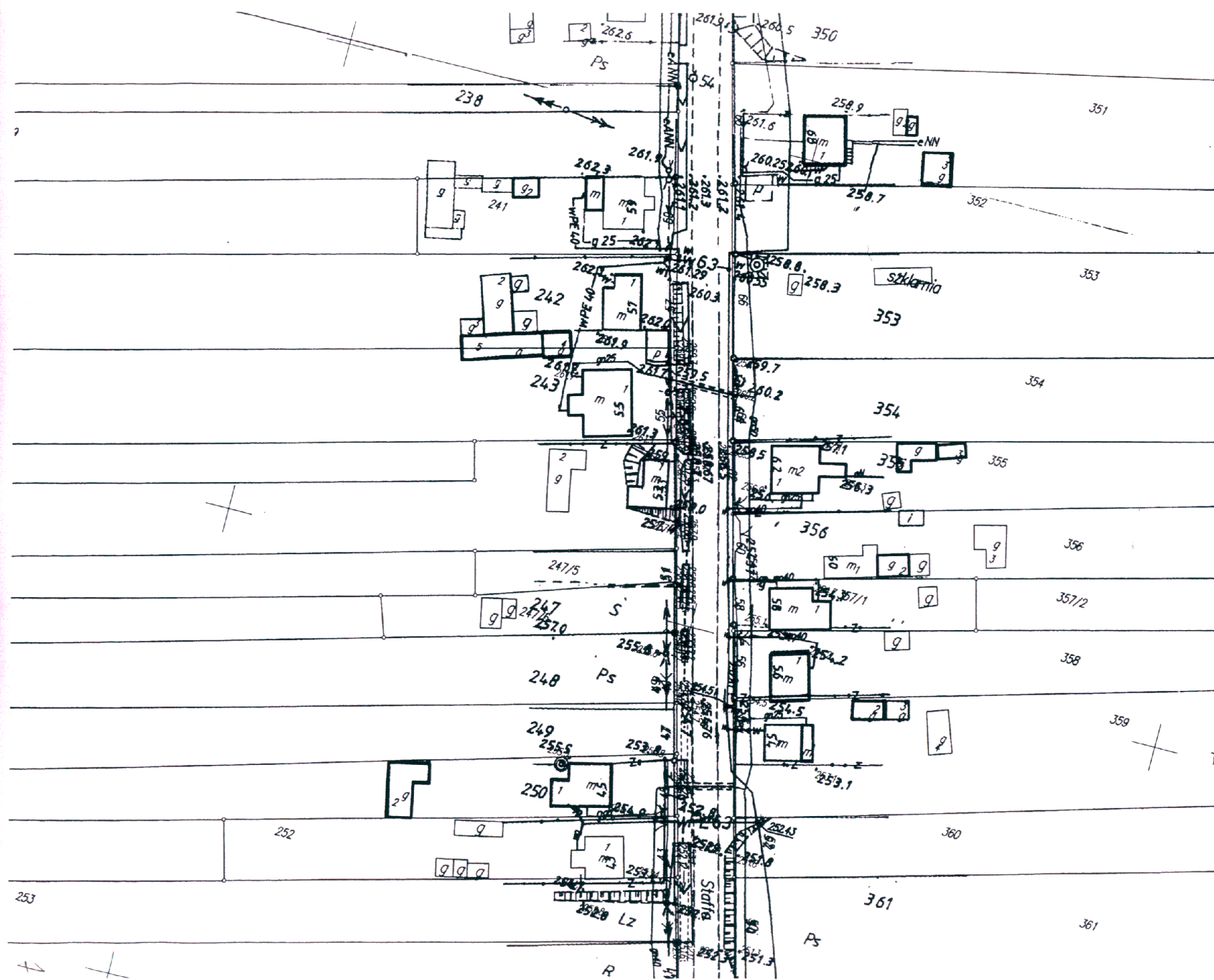

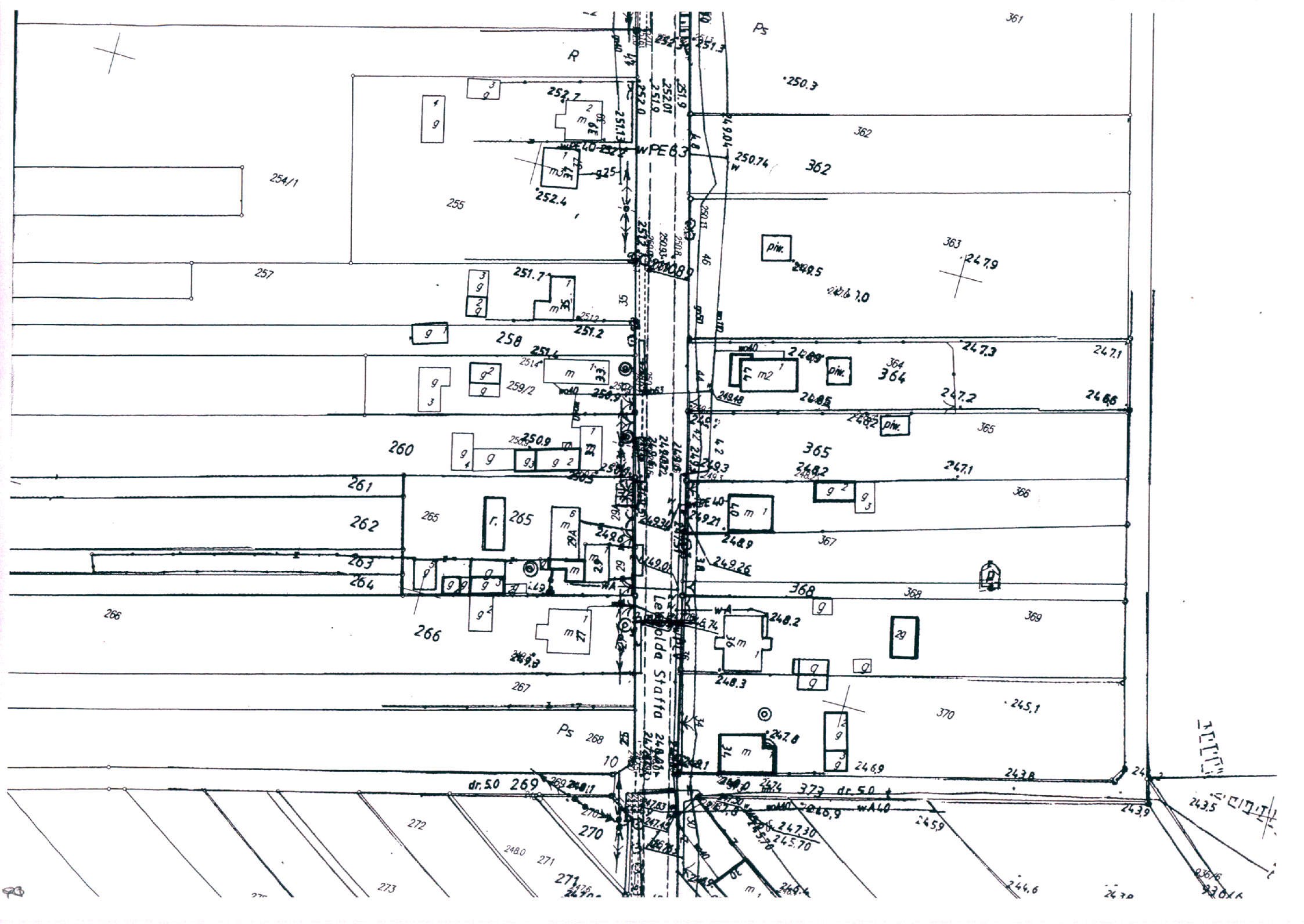



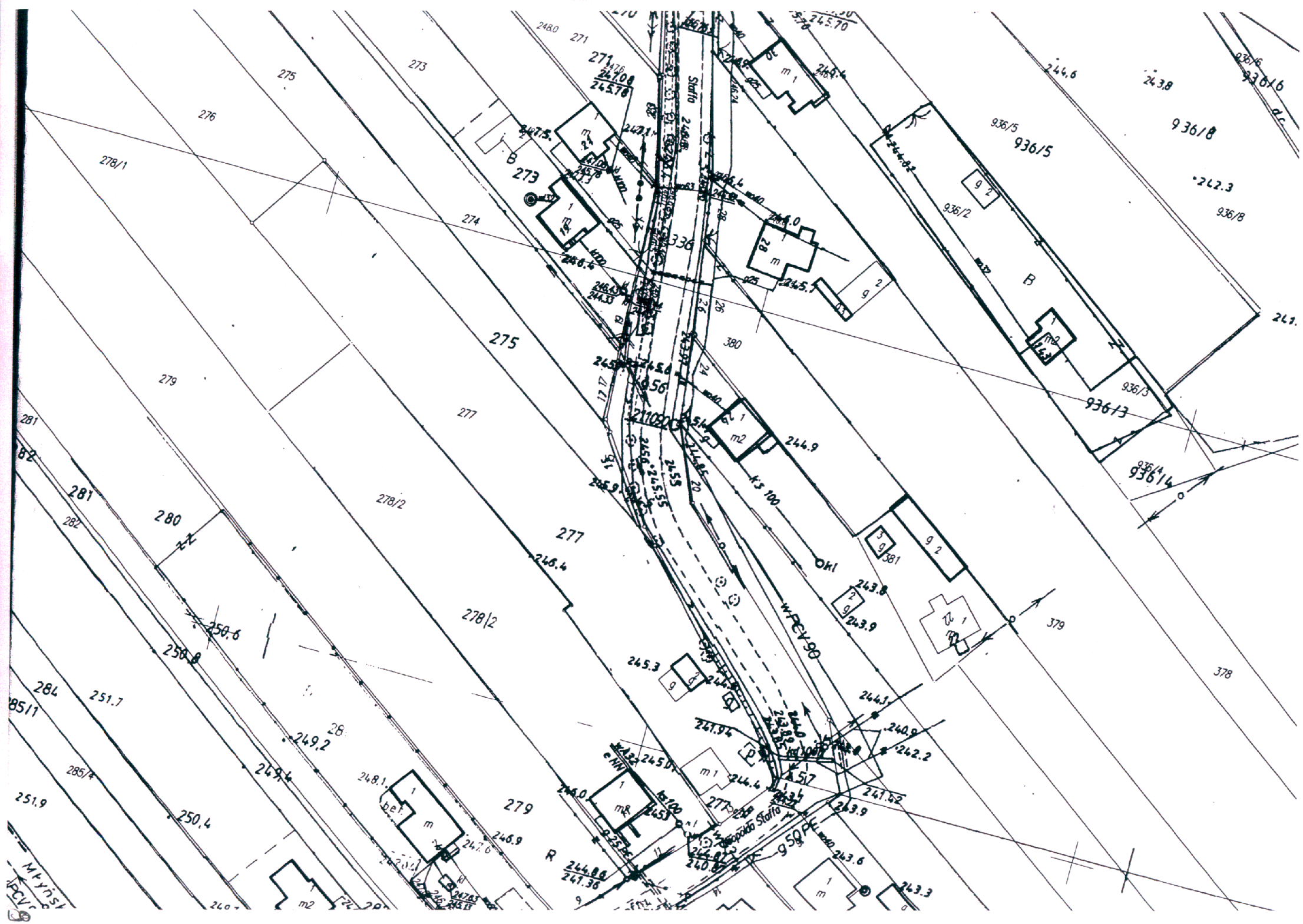

MPYDSE  
PCV

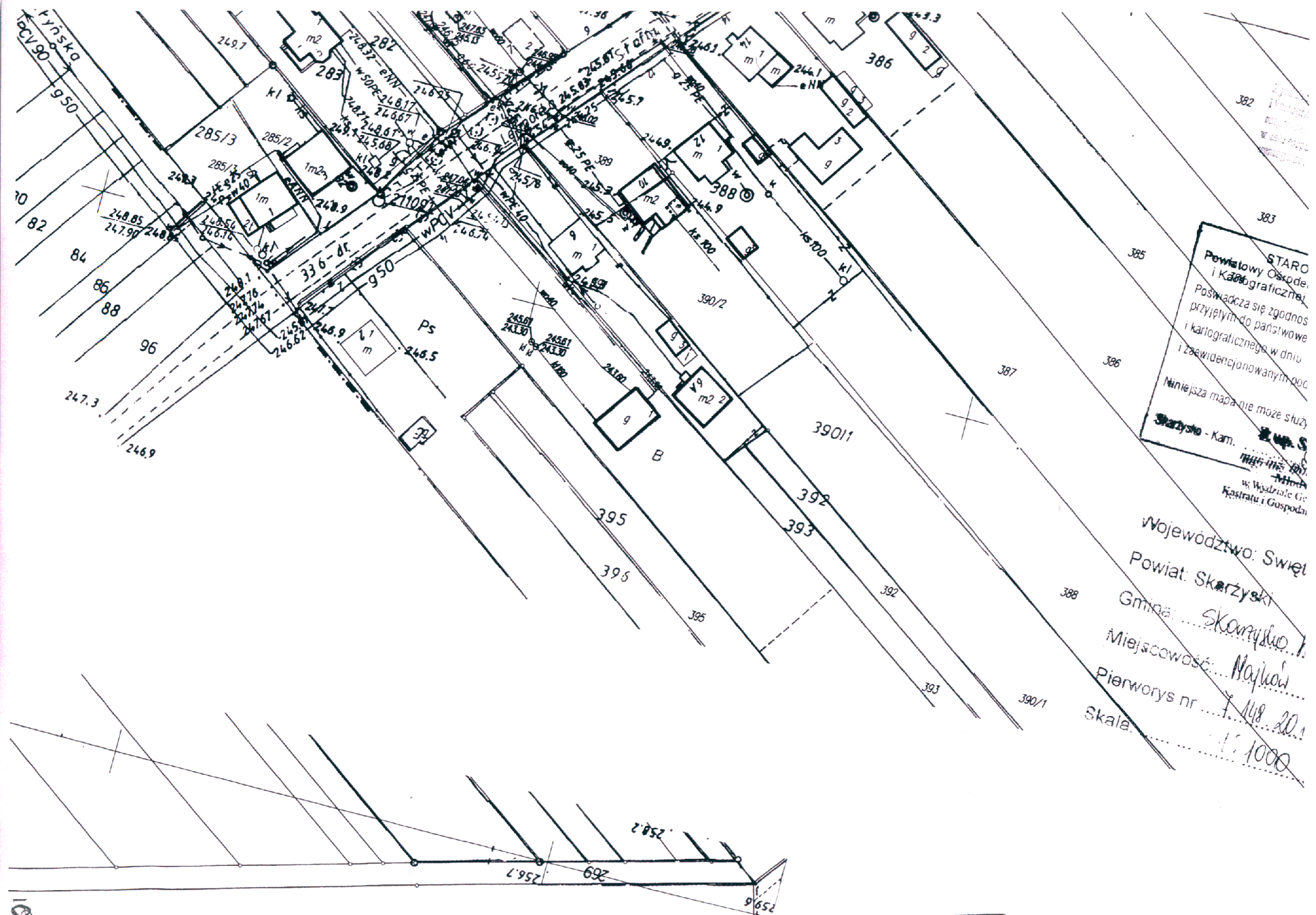

STARO  
 Powiatowy Osrodek  
 i Kartograficzny  
 Poświadczam się zgodnos  
 przyjętym do państwowo  
 i kartograficznego w dniu  
 i zaewidencjonowanym doc  
 Niniejsza mapa nie może służy  
 Skarżyno - Kam. **Skup. S**  
 w Wydziale Ge  
 Kastratu i Gospodar

Województwo: Święt  
 Powiat: Skarżyski  
 Gmina: Skarżysko  
 Miejscowość: Majków  
 Pierworys nr: 148.20.1  
 Skala: 1:1000

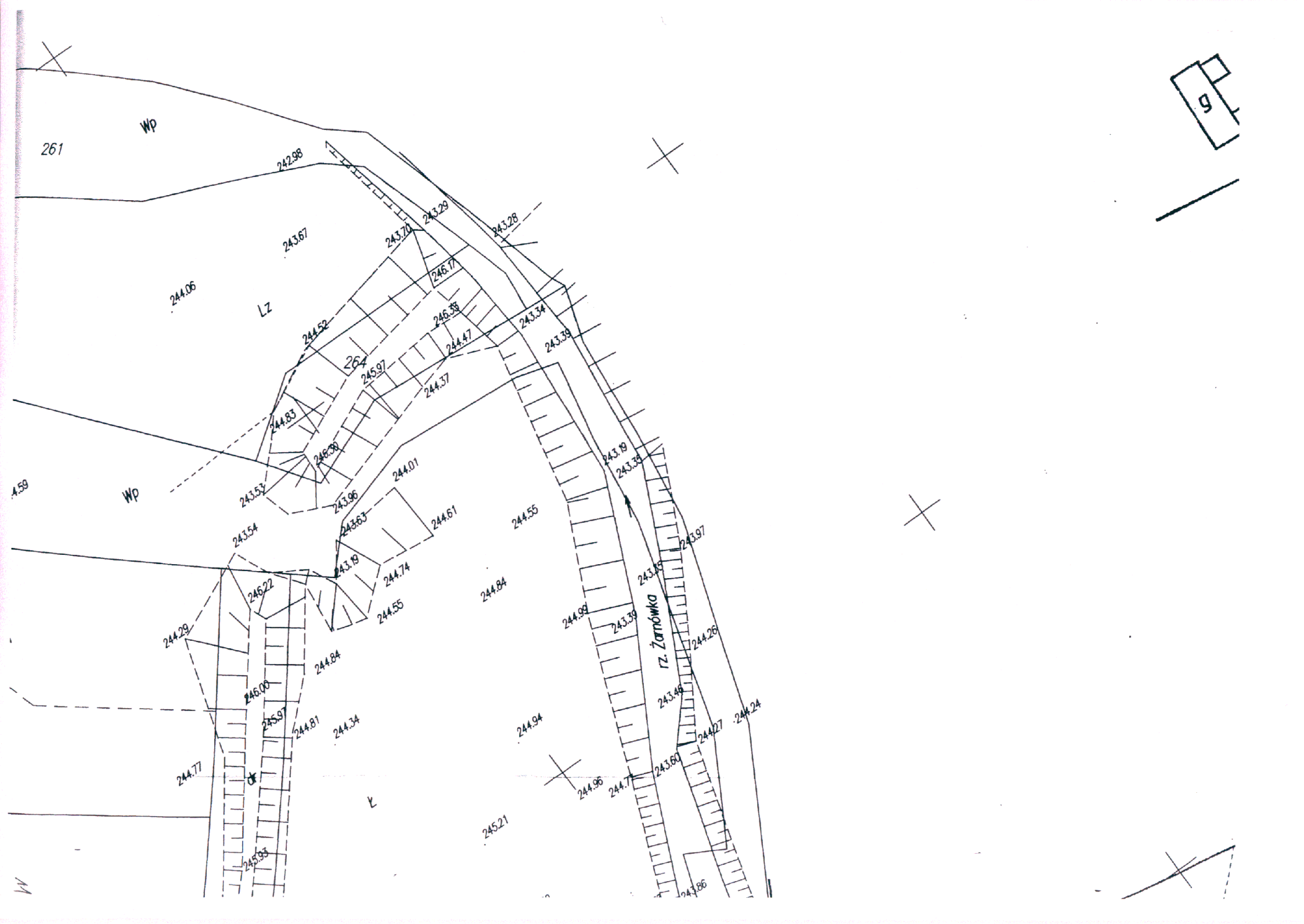

261

WP

242.98

243.67

243.70

243.28

244.06

LZ

244.52

246.17

246.35

243.34

243.39

264

245.97

244.47

244.37

244.83

246.39

244.01

243.19

243.35

A.59

WP

243.53

243.96

243.63

244.61

244.55

243.54

243.19

244.74

244.84

244.99

243.39

243.85

243.97

244.29

246.22

244.84

244.55

243.85

244.26

246.06

244.81

244.34

244.94

244.96

244.7

243.60

244.27

244.24

244.77

245.95

245.21

243.86

rz. Żarnówka

9

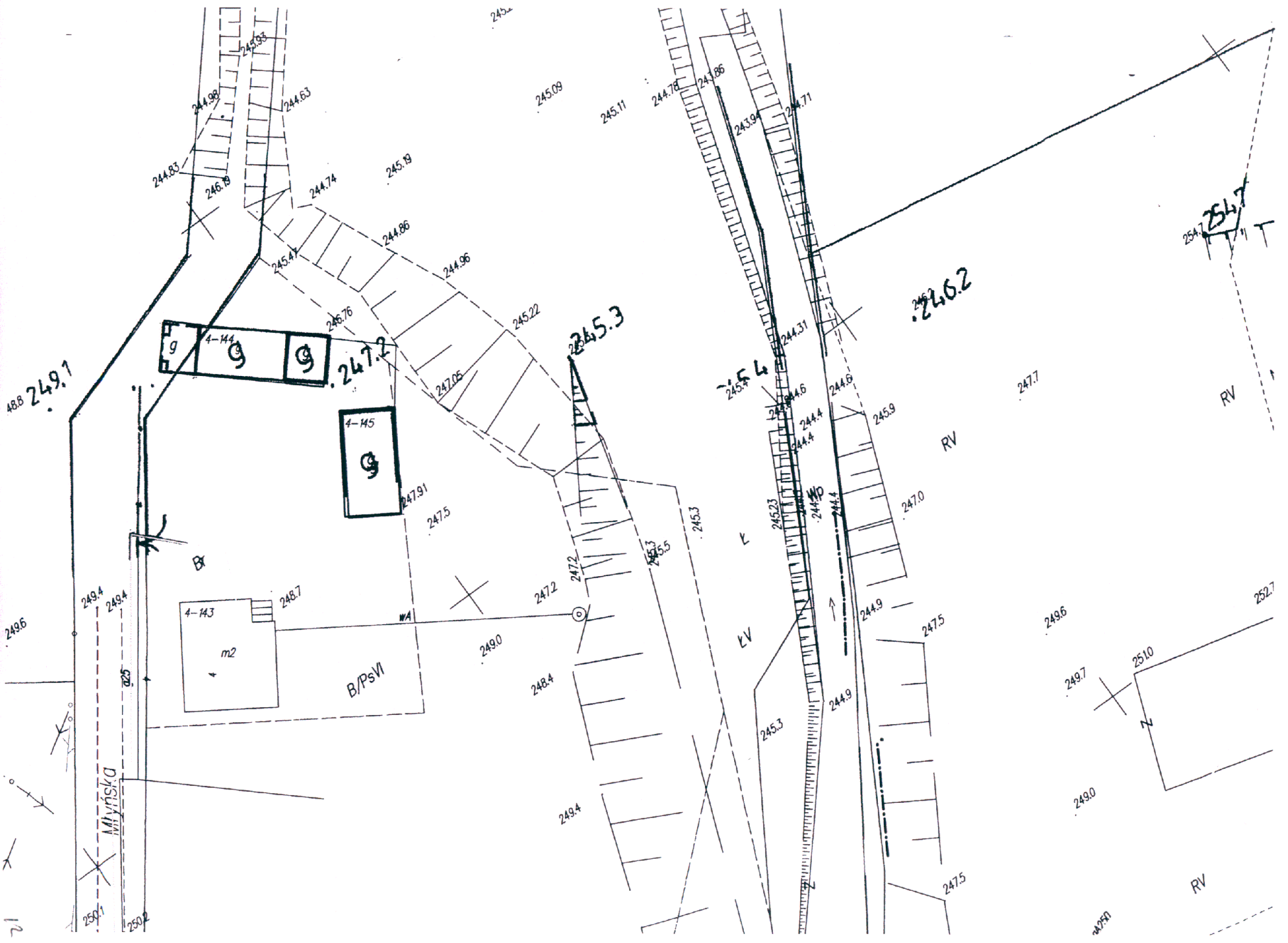

254.7

246.2

249.7

245.3

245.4

247.2

RV

RV

Z

LV

B

B/PsVI

m2

D. SIVSKO

12



Ps

gm. Sk  
obr

gm. Wąchock  
obr. Parszów

ciepl

ciepl

R

WP

LV

84540

84541

RV 84542

PsV

265

Lsv

4-265/2

RV

WODOKANALIZACJA

Główna

25149

2537

2522

2537

4-263/3

256.2 j. asfalt.

256.3

249.45

250.4

249.7

248.7

250.1

245.9

245.4

245.4

245.8

247.6

248.6

249.4

250.4

251.0

251.4

251.4

249.50

250.1

245.5

248.3

251.4

251.6

252.1

252.9

252.2

245.5

248.3

251.4

251.6

252.1

252.9

252.2

247.1

247.1

246.7

253.9

254.0

254.8

257.0

253.0

249.8

246.3

246.3

246.0

247.1

247.4

249.3



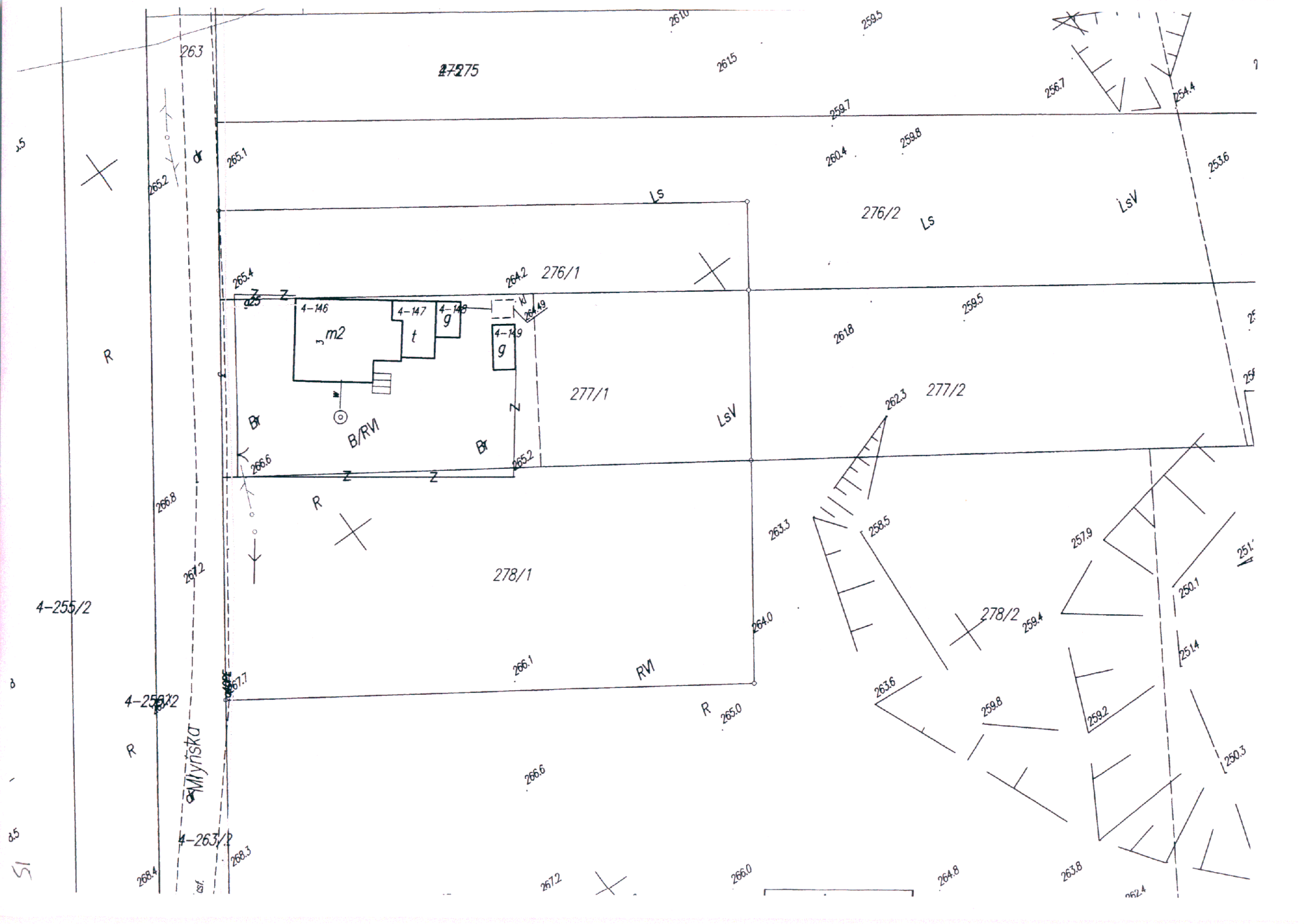

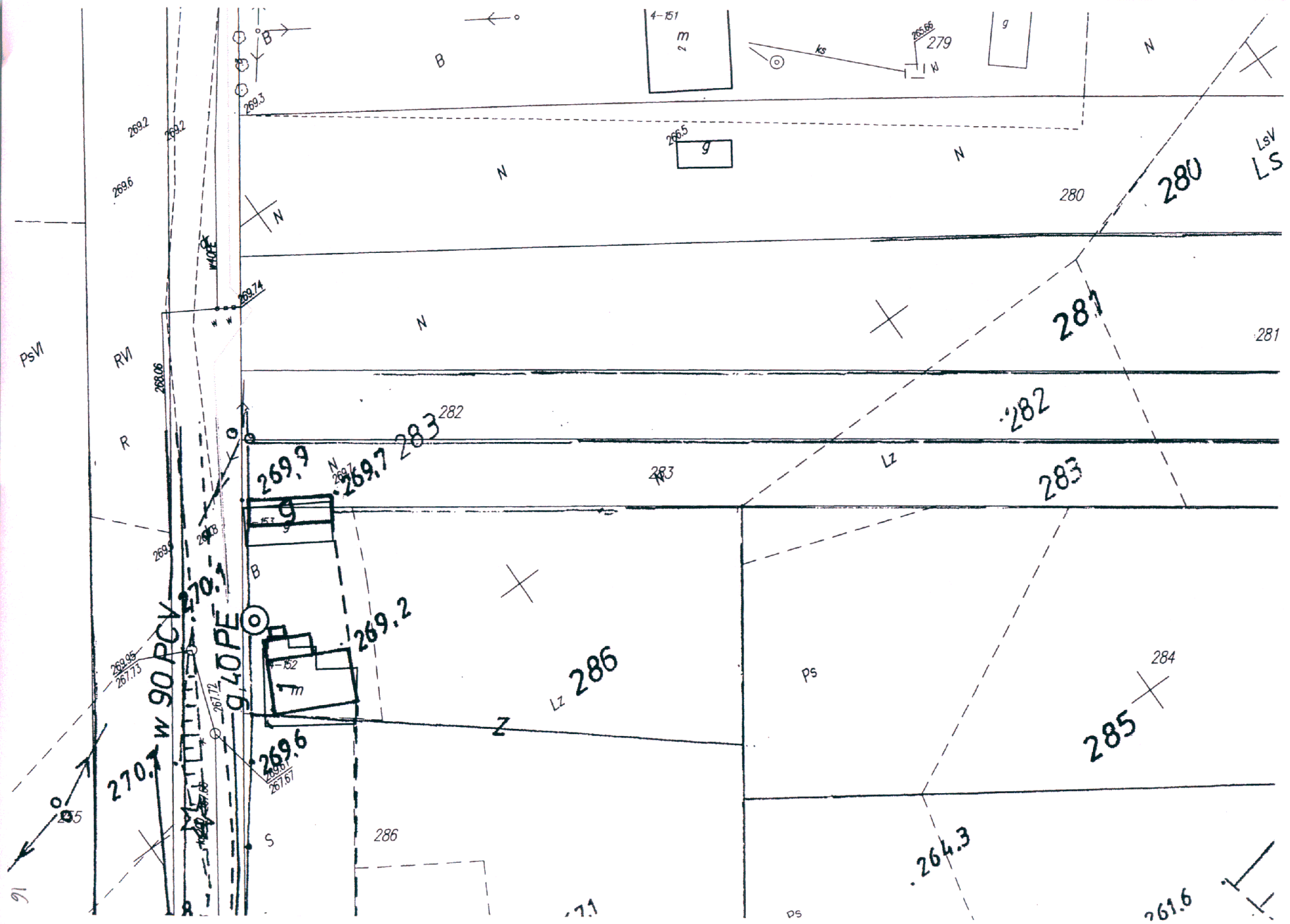

PsVI

RVI

R

91

270.1  
W 90 PCV  
GLOPE

g  
m

g  
m

g  
m

4-51  
m

g

g

B  
269.3

B

ks

265.66  
279

N

269.2  
269.2  
269.6

N

N

266.5

N

280

280

Lsv  
LS

269.74

N

281

281

269.9  
269.7  
283

283

282

283

B

269.2

Lz 286

Ps

284

285

269.6  
267.61

S

286

287

264.3

Ds

261.6



255

256

256

285

285

268.5  
268.5  
267.41  
267.30  
267.30  
267.28  
267.28  
267.11  
267.09  
267.09  
268.57  
267.00  
268.57  
267.36  
267.36  
268.48  
267.70  
268.64  
266.88  
266.82  
266.80

262.3

262.2

259.8

9 40 PE

248.0

262.8

264

267.2

ps

262.8

Ls

264.9 ps

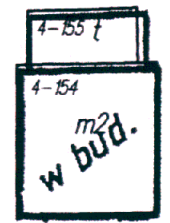

267.9

287

R

265.5

267.0

f1

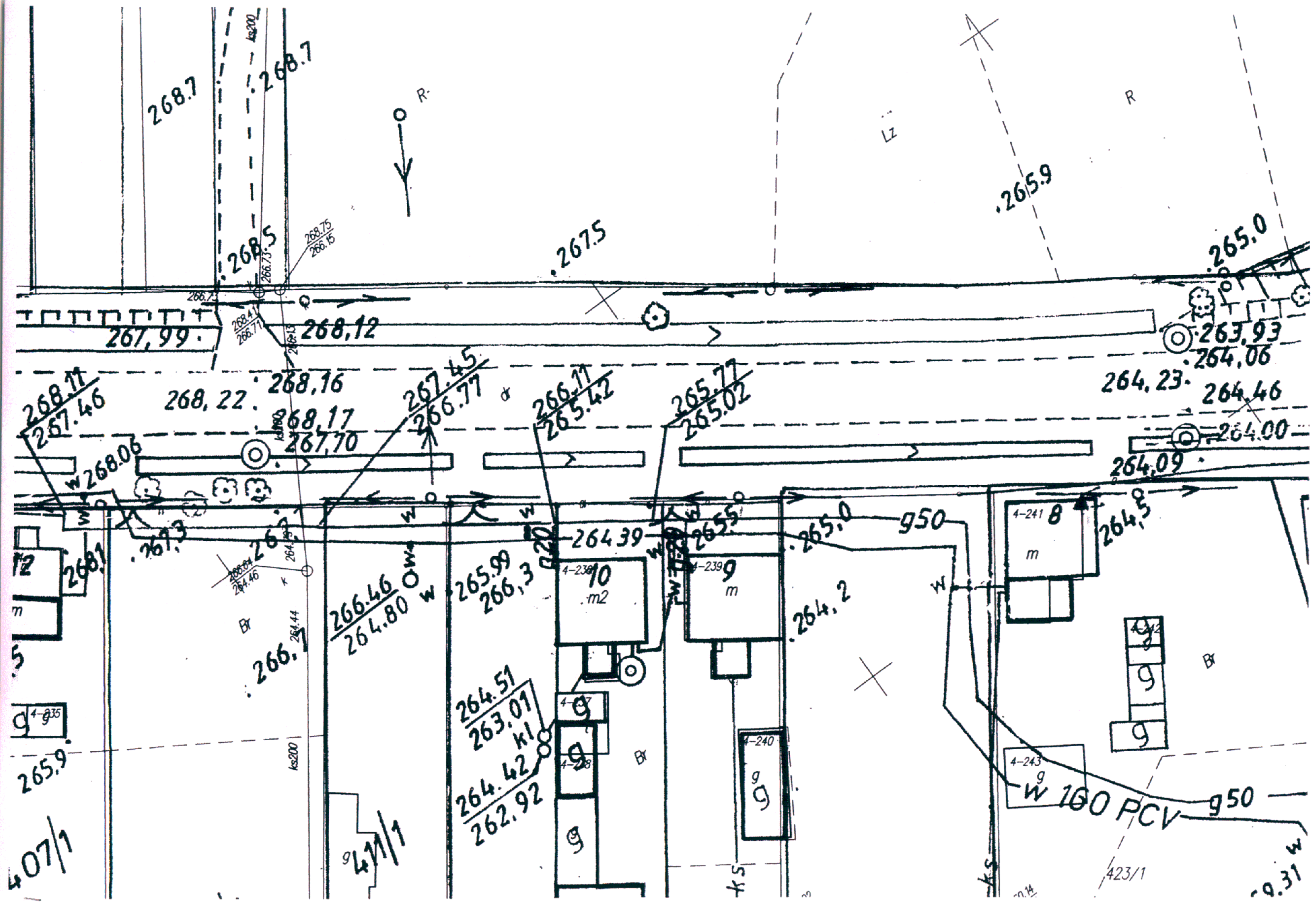

407/1  
81

471/1

423/1  
9.31 w

12  
m  
5  
g  
4-235

g  
g  
g  
g  
4-238  
4-237

4-241  
m  
g  
g

g  
g  
g

4-243  
g  
W 160 PCV 950

4-240  
g  
g

268.7  
268.7  
As200

265.9

267.5

265.0

268.11  
267.46

268.22  
268.16  
268.17  
267.70

267.45  
266.77

266.11  
265.42

265.77  
265.02

267.93  
264.06  
264.23  
264.46

264.00  
264.09

268.1

265.9

266.7  
264.44

266.46  
264.80

265.99  
266.3

4-238  
10  
m2

4-239  
9  
m

265.0  
264.2

264.9

4-243  
g  
W 160 PCV 950

423/1

9.31 w